

AJ 105

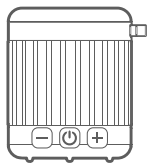

USER MANUAL

ENG & CHN

AJ 105

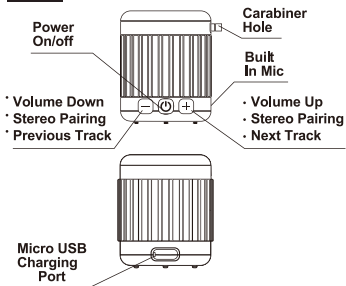

ENG

Pairing One Speaker (Mono Mode)

1. Power on: Press and hold Power ON/OFF button for 4 seconds a sound prompt will indicate the AJ105 is powered on.
2. The AJ105 will automatically enter pairing mode and begin searching for other Bluetooth wireless enabled devices.
3. In the Bluetooth settings of your Smartphone, tablet, or media player switch Bluetooth ON and select the option to "Search for Devices".
4. Find & select (tap) "AJ 105" on your Smartphone/ Tablet to complete a successful pairing. (If prompted for a passcode use 0000.)

ENG

Tips to Get The Best Reception and Audio Quality

To get the best stereo quality, the distance between two paired speakers should not exceed 5 M.

Bluetooth Wireless Range In A Dry Environment

The AJ 105 has a wireless range of up to 10 meters. To get the best reception ensure there is a clear line of sight between your AJ 105 and your bluetooth enabled device. Obstructing objects between your AJ 105 and your device may compromise the range and cause interference with your connection. For best results ensure that your phone is pointed directly at the AquaJam logo on the front face of the unit. To get the best audio quality, ensure the speaker grill is facing you and the unit is either positioned on its side grips or upright on the base grip.

ENG

- If your device does not auto-link when within range, re-pair the device. To do so, first delete AJ105 from your Bluetooth devices menu.
- Make sure your device is working properly. Check your device's manual for details on Bluetooth pairing and linking.
- Reconnect your Bluetooth device to the speaker if you've recently deactivated Bluetooth on the device. Go over the settings on your device and confirm they're set up to stream over Bluetooth.

Still need help?
One of our AQUAJAM technical support specialists can assist you with your issue. To reach us please contact the AQUAJAM support team and send an e-mail to the support@aquajam.com e-mail address.

ENG

IMPORTANT!

THIS PRODUCT IS WATERPROOF ONLY IF THE INSTRUCTIONS ARE FOLLOWED. AVOID SUBMERGING THE PRODUCT BELOW 1M AND ALWAYS ENSURE THAT THE CHARGING CAP IS SECURED TIGHTLY BEFORE USE. TO ENSURE THE BEST AUDIO QUALITY THE SPEAKER SHOULD BE FULLY CHARGED BEFORE USE.

USB Charging Connection

Charge the unit by connecting the USB cable from the charging port to your chosen USB power supply such as a power bank, computer or USB adapter.

The Micro USB charging port is located on the side of the unit. Unplug the protective cap to gain access.

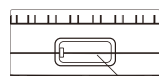

MICRO USB CHARGING PORT

The speaker performance and sound may vary when wet.
**For optimal performance the battery should be fully charged before first use.

Bluetooth Wireless Range In A Wet Environment

As water absorbs bluetooth signals the wireless range will lessen when the AJ 105 comes into contact with water. To maximize the range ensure that there is a clear line of sight between your Bluetooth enabled device and the AJ 105. Avoid submersing the AJ 105.

Audio Quality In A Wet Environment

If water enters the speaker grill the audio quality will be temporarily compromised. To resume normal sound invert the speaker allowing for the water to drain out of the grill. The speaker should dry up quickly and normal audio quality will be restored.

Care & precautions

1. Do not install near any heat sources such as radiators, heat registers, stoves, or other apparatus that produce heat.
2. For protection during lightning storm, unplug the speakers from the electrical outlet and turn off the computer.
3. Unplug this apparatus when unused for long periods of time.
4. Place the AJ 105 in a stable location so that it will not fall causing damage to the speaker.
5. Close the charging port securely. If the unit is placed in water without the cap being sealed the warranty will be invalid.
6. Dry unit completely before opening the charging port. Do NOT open the cap if wet or in a wet environment. Do NOT use or store the unit in places with high temperature.

The AJ 105 is an extreme climate, waterproof, full range wireless speaker system with built-in rechargeable battery. Stream & Play your music from your Bluetooth enabled devices such as Smartphone, Tablet or Laptop. Take and make phone calls thanks to the built-in microphone.

What's included:

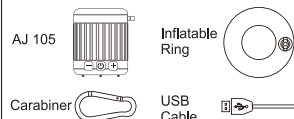

ENG

Warning: If the Protective Cap is off or loosely secured then the speaker is NOT watertight and can cause damage to the speaker. To maintain a watertight seal, make sure the Protective Cap is plugged in firmly.

Charging the Battery: Playtime lasts up to 8 hours at 80% volume on a full charge. The built-in Lithium Ion battery uses the included USB cable to recharge for optimal charging connect the USB cable to your computer or any USB wall or car adapter that outputs a minimum of 5V@500mA or higher. The red LED will stay on during charging and turn off when charging is complete. The typical charging time for a full charge is approximately 3 hours.

Audio quality may be effected when the battery is drained.

ENG

Pairing Two Speakers (Wireless Stereo)

1. Press the power ON/OFF button which is located at the front of the speaker for a few seconds to power on the units. Tones and voice prompt will sound and each speaker will flash at the bottom.
2. Press and hold the + and - buttons at the same time on both units to enter the pairing mode to link each other units.
3. Once wireless audio link is successful a tone will sound to indicate the connection.
4. To pair the speakers with your device please follow the pairing procedure as mentioned in Mono mode (Pairing One Speaker).

** The unit will remember the last paired speaker.

Troubleshooting

1. The speaker doesn't play

- Press the power button and make sure the unit is powered on.
- Make sure the speaker is charged. If you are not sure that the battery is charged attach the charging cable to the AJ 105 and plug the other end into any active USB port.
- If connected wirelessly check status of the device that is connected. Make sure that the AJ 105 is paired - connected and that the media is playing.
- Try turning the power Off then back On.

2. Poor sound quality and static

- Charge the battery

Inflatable Ring

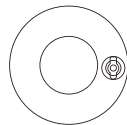

A life ring has been included in the packaging. This has been designed to fit around the AJ 105, allowing the speaker to float with the speaker side facing up so you can enjoy your tunes in the water. To use the life ring Inflate it so it fits comfortably around the AJ 105 with the speaker side facing up. Please note that as water absorbs bluetooth signals it may shorten the normal operating distance from your device to the speaker.

Power ON/OFF

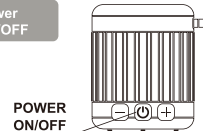

1. Once fully charged turn the speaker on by pressing the power button for approximately 4 seconds until you hear a sound prompt.
2. Long press the power button for approximately 4 seconds a sound prompt will indicate that the unit is powering down. The LED will turn off. The unit is powered off.
3. When not in use the speaker will power off automatically after 5 mins.

MIC / Answering Calls

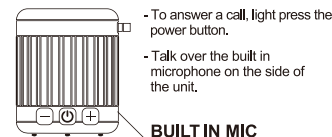

- To answer a call, light press the power button.
- Talk over the built in microphone on the side of the unit.

- For best results, speak within 50cm (20") of the Microphone during a call.
- To hang up a call, light press the power button.
- If two speakers are paired, use the left channel to control your calls.

- The system is designed to operate at a range of 10 meters. However, performance can be diminished by obstacles such as walls or metal, and may also be affected by other Bluetooth® devices. Try moving the AJ 105 speaker closer to the Bluetooth® device.

3. Unsuccessful Pairing

Bluetooth implementation varies depending on your device's hardware and operating system.

- When you power ON the speaker, it will automatically link with the last previously paired Bluetooth device if the device is still within range (about 10 meter). To pair with a different device, disconnect the speaker from your paired device.



ENG